

TECHNICAL DATA		120 L
Nominal capacity	L	114
Unladen weight	Kg	43
Dimensions (Ø/height)	-	Ø530 / 1350
Cylinder material	-	inox
Polyurethane insulation	mm	50mm
Power supply	-	230 / 50Hz
Thermal power	W	1550
Power consumed HP (average-max)	W	230 - 350
Electric support power	W	1500
Refrigerant fluid	-/Kg	R134a / 0,7
Consumption profile	-	M
Energy-efficiency class (air at 14°C)	-	A+
Energy-efficiency (air at 14°C)	%	117
Energy-efficiency (air at 20°C)	%	129
COP (air at 14°C)	-	2,80
COP (air at 20°C)	-	3,10
Useful water quantity at 40°C	L	139
Annual electric consumption (air at 14°C)	kWh	438
Ambient temperature limits	°C	-5 / 40
Maximum pressure	Bar	7
Max temperature DHW (HP)	°C	60
Max temperature DHW (support)	°C	70
Sound pressure at 2m	dB(A)	34
Pipe diameters	mm	Ø125 / Ø150
Static pressure of fan	Pa	60
Max. distance of pipes <sup>1</sup>	m	20

<sup>1</sup> Considering curves of 90° and grilles on the equipment air inlet and outlet.

Equipment: **MONOBLOC 120**

Dimensions: **Milimeters**

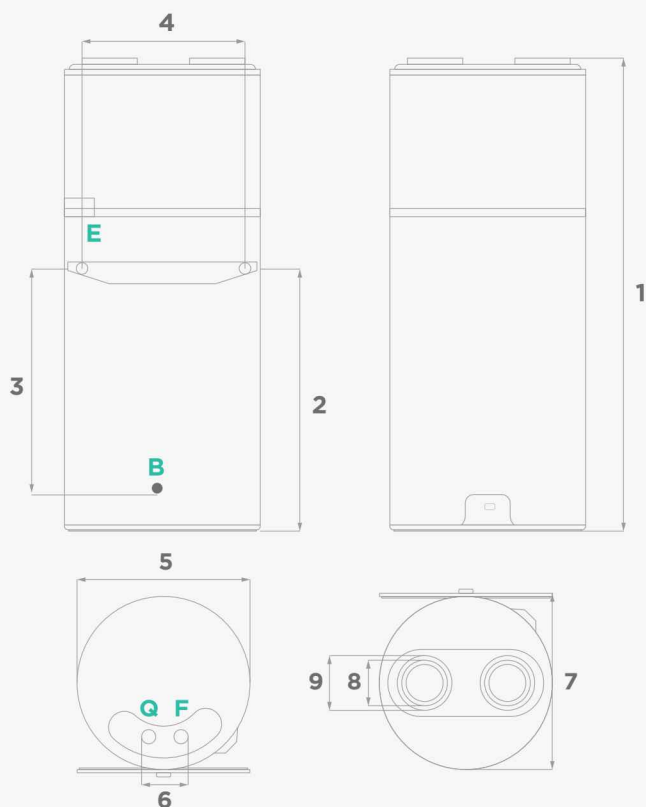

120 L	
1	1350
2	808
3	693
4	450
5	Ø530
6	100
7	550
8	Ø125
9	Ø150
Q	3/4" M
F	3/4" M

- Q.** Hot Water
- F.** Cold Water
- E.** Condensate Sewage
- B.** Lower Buffer